

Jonathan Hunt

ESTATE AGENCY

20 High Street Ware SG12 9BX

Tel: 01920 411090

8 High Street Buntingford SG9 9AG

Tel: 01763 272727

info@jonathan-hunt.co.uk

www.jonathanhunt.co.uk



1 Green Man Cottages High Street, Widford, Hertfordshire, SG12 8SR

£279,995

JONATHAN HUNT are pleased to offer this charming TWO BEDROOM COTTAGE located within the popular village of Widford. The property offers open plan living accommodation with modern Kitchen and Bathroom suite., Please call 01920 411090 to arrange your viewing. CHAIN FREE

Buntingford Branch - Company No. 10303541 VAT No. 10303541

Ware Branch - Company No. 4759215 VAT No. 700174975

1 Green Man Cottages High Street, Widford, Hertfordshire, SG12 8SR

LIVING AREA 19'8 x 12 (5.99m x 3.66m)



BEDROOM TWO 10'6 x 7 (3.20m x 2.13m)



KITCHEN AREA



BATHROOM



FIRST FLOOR

BEDROOM ONE 10'4 x 8'10 (3.15m x 2.69m)



Energy Efficiency Rating		Current	Potential
Very energy efficient - lower running costs			
(92 plus) A			90
(81-91) B			
(69-80) C			
(55-68) D			
(39-54) E		71	
(21-38) F			
(1-20) G			
Not energy efficient - higher running costs			
England & Wales		EU Directive 2002/91/EC	

Environmental Impact (CO ₂) Rating		Current	Potential
Very environmentally friendly - lower CO ₂ emissions			
(92 plus) A			90
(81-91) B			
(69-80) C			
(55-68) D			
(39-54) E		71	
(21-38) F			
(1-20) G			
Not environmentally friendly - higher CO ₂ emissions			
England & Wales		EU Directive 2002/91/EC	

GROUND FLOOR

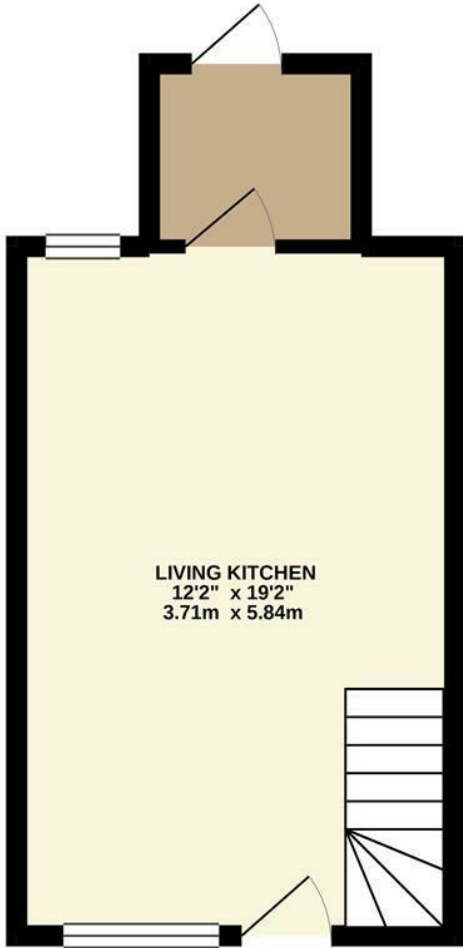

1ST FLOOR

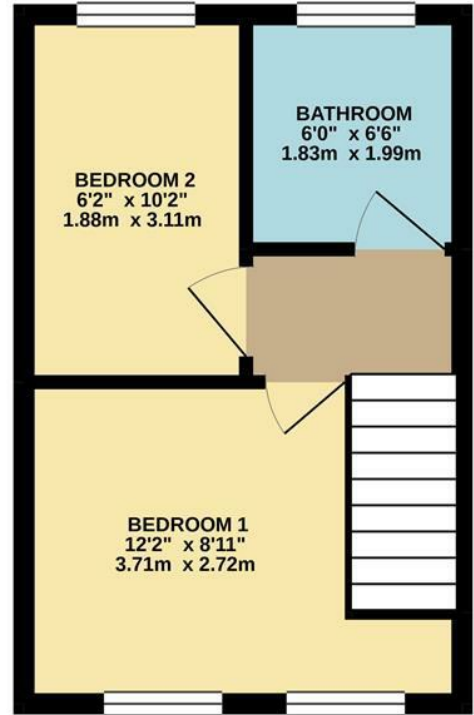

Whilst every attempt has been made to ensure the accuracy of the floorplan contained here, measurements of doors, windows, rooms and any other items are approximate and no responsibility is taken for any error, omission or mis-statement. This plan is for illustrative purposes only and should be used as such by any prospective purchaser. The services, systems and appliances shown have not been tested and no guarantee as to their operability or efficiency can be given.
Made with Metropix ©2020